

INSTALLATION MANUAL

TACKER

PRECAUTION

● SAFETY INSTRUCTIONS

The product is a flammable liquid chemical which using petroleum distillate as a part of the raw material. Do not use it with other substances, and keep away from hot surfaces, heat, sparks, flames and other sources of ignition in handling. In addition, it may cause severe eye irritation and have sleepiness or dizziness and allergic skin reactions. Also, the intentional misuse through vapor inhalation can be fatal, so you should never try it.



● FIRST AID :

If In Eyes : Immediately flush the eye with plenty of fresh water for at least 15 minutes and seek medical attention.

If On Skin : Wash the contaminated area off with water and soap.

If Swallowed : Do not induce vomiting and seek medical attention immediately.

If Inhaled : Breath in fresh air, and, if abnormal symptoms persist, seek medical attention.

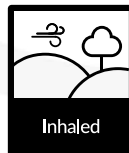
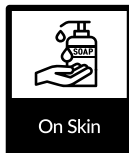

● WARNING !

Keep it away from children and pets. Storage it indoor space of 60°F~90°F (15°C~32°C) without direct sunlight. Should never be frozen.

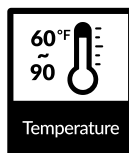

● SHELF LIFE

Please meet strict expiration dates to maximize product efficiency.

- 2 year in the original sealed packaging
- 6 months after opening



INSTALLATION

● WORK ENVIRONMENT

- It is recommended to work indoors without direct sunlight and to minimize dust
- Illuminance should be as bright as possible. It is recommended to use 3 wavelength LED when using artificial light.
- The film has a good elasticity and does not affect the adhesive when your workplace is the temperature of 25° / 77°F.

● BEFORE SPREAD

- STEP.1** clean the adhesive surface to remove any remaining gel or glycerin solution used during application, using water or alcohol.
- STEP.2** Ensure that the surface is completely dry.
- STEP.3** Shake the bottle up and down thoroughly several times.

● SPREAD

- STEP.4** Spray onto the adhesive surface of the area where the solution is to be applied.

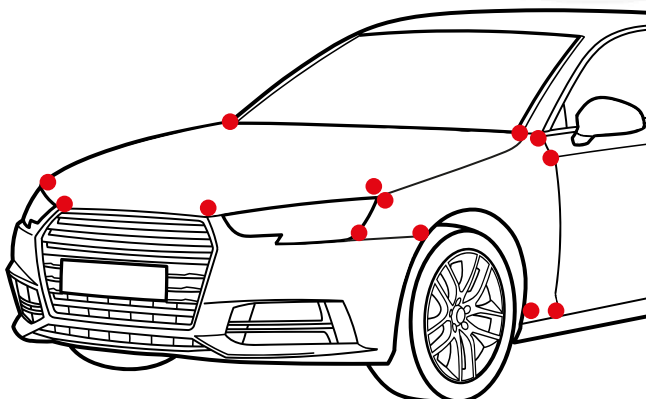

Tip ①

Spray the solution only onto the adhesive surface of the application area and avoid contact with the film's topcoat surface. If the solution comes into contact with the topcoat surface, temporary haze may occur for approximately 5-10 minutes.

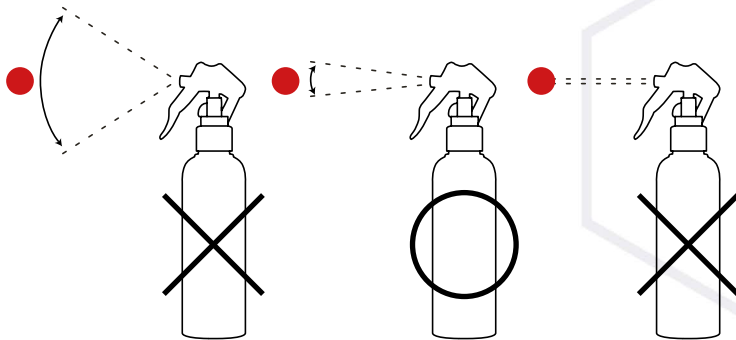

Tip ②

Adjust the spray nozzle to control the spray volume, ensuring application only to the designated areas.



STEP.5

After applying the solution, wait 2–3 minutes to activate adhesion.

STEP.6

Apply the film by following along the surface using your fingertips (while wearing high-heat-resistant gloves) or a square hard card with felt attached.

STEP.7

Apply heat using a heat gun at the appropriate temperature (200°C / 390°F).

